

Venue Visual Story

Lobe Spatial Sound Studio



Template prepared by PuSh Festival

About Lobe

Lobe is located at 713 E Hastings St. in Strathcona

This venue is across the street from the Vancouver Public Library, náčá?mat ct Strathcona Branch

- 713 East Hastings Street
- Close to the intersection of East Hastings St and Heatley Ave.



Here is a picture of the front entrance. Knock on the front door for assistance entering.

Directions and Parking

[View map on Google maps](#)

Driving/Parking

There is free parking on Hastings St.

There is metered street parking nearby.

There are no accessible parking spots nearby

- **Green** means 2 hr Free Parking
- **Yellow** means Paid Parking

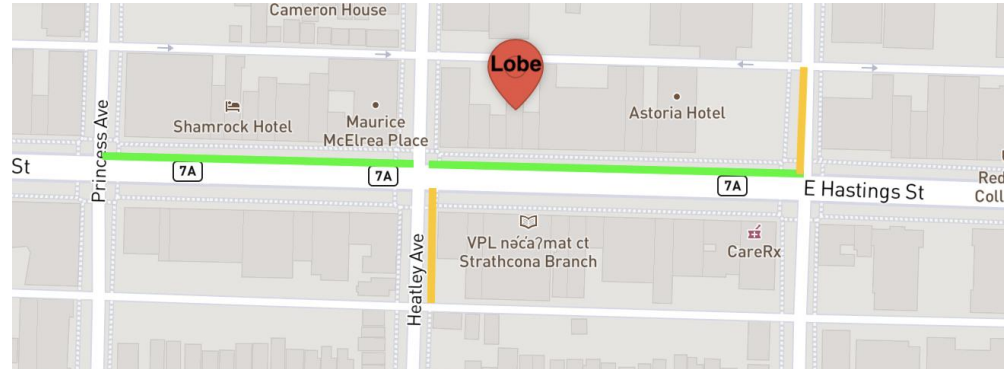

Here is a map of the street parking.

Public Transportation

[View routes on Google maps](#)

Bus

- 10 *Downtown / Granville* on Hastings Street
- 14 *Hastings / UBC* on Hastings Street
- 16 *Arbutus / 29th Avenue Station* on Hastings Street
- 20 *Downtown / Victoria* on Hastings Street
- Bus stop going West is 90 metres away
- Bus stop going East is 170 metres away

When walking from [the bus stop](#) on the South side of Hastings



This is what the [#50937] bus stop looks like
From here, walk east (same direction as the bus)



After you cross Princess avenue you will arrive at
Heatley avenue, cross the street



Cross again to the north side of Hastings.
Then turn right



The Lobe studio is this black building,
the 4th building on this block

When walking from the nearest [bus stop](#)
on the North side of Hastings Street



This is what the [#50504] bus stop looks like



Walk east, you will have to cross Princess Avenue
and Heatley Avenue on your way

PuSh
INTERNATIONAL
PERFORMING ARTS
FESTIVAL



The Lobe studio is this black building,
the 4th building on this block

Inside the Building



Here is a picture of the lobby from the front entrance.



Here is a picture of the studio from the lobby entrance.

Box Office



This is front desk where you can check in with the Lobe team.

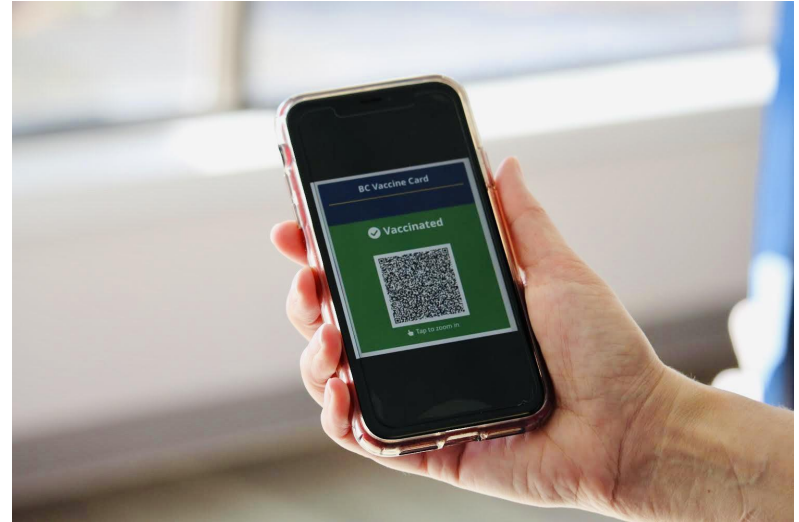

The Lobe team will check your ticket, vaccine passport, and ID

Food & Beverage

There is a water station in the lobby.



This is free water with cups available in the lobby.



Going into the Studio

There are 2 steps to enter the event space
from the lobby.

Inside the Studio



There will be some chairs
and some mats and pillows so sit or lie on

The light inside the studio can change colour.

When the show starts, the lights will fade and
it will become quite dark. The exit lights will
always stay on.

You can leave the studio at any time and wait
in the lobby for the show to finish.

Washroom at Lobe



The washroom at Lobe is gender neutral. It is a small space and there are 2 steps down to the washroom. There is an accessible washroom at the Library across the street that is open from Mon-Fri 9am-9pm ; Sat & Sun 9am-6pm

Accessible Washrooms at Vancouver Public Library



View of accessible washroom door

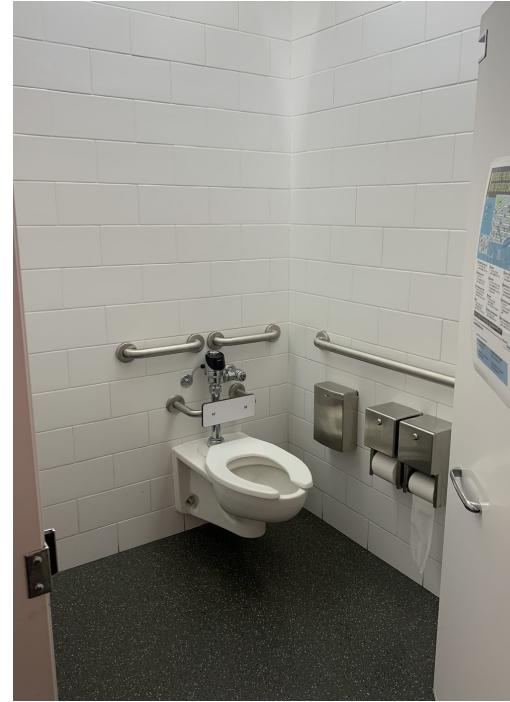

View of accessible washroom

Chill Out Zone

You can leave the studio anytime you want and go back into the lobby.



There will be:
Comfortable seats
A water station
Staff to help you

Lobe Studio Ground plan

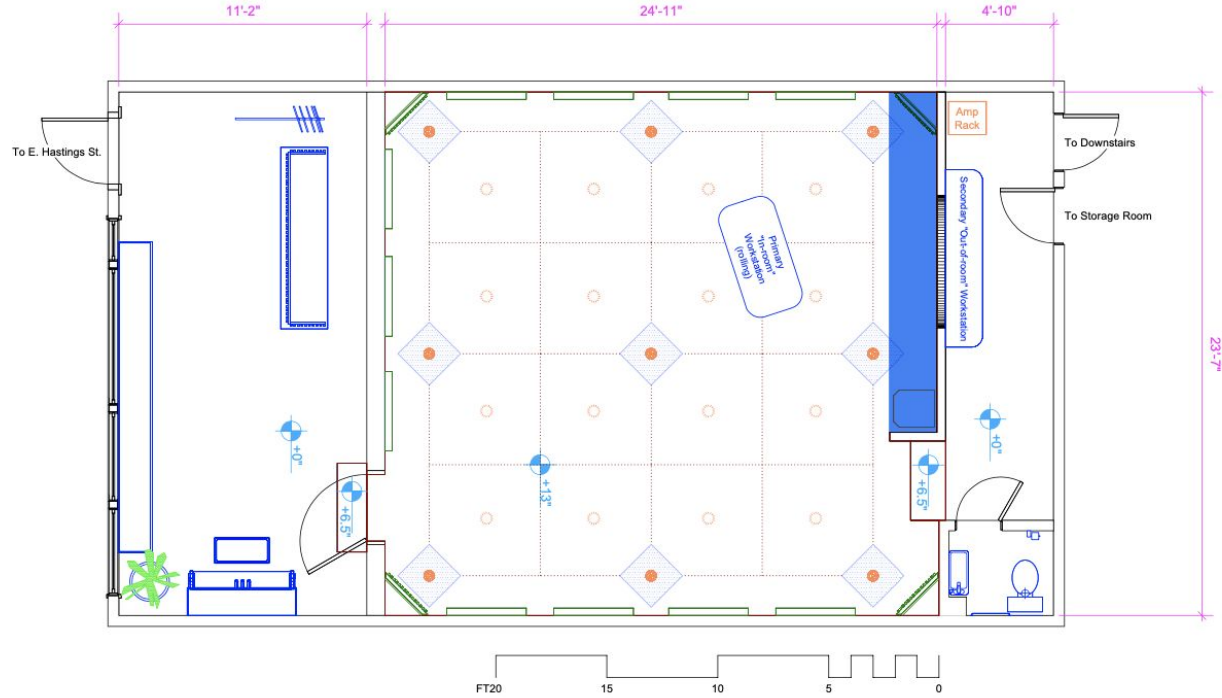

	Lobe Studio
	Lobe Studio, Vancouver
	Recording Special Sound
	2025-2026 2025-2026 2025-2026

Lobe Studio Elevation

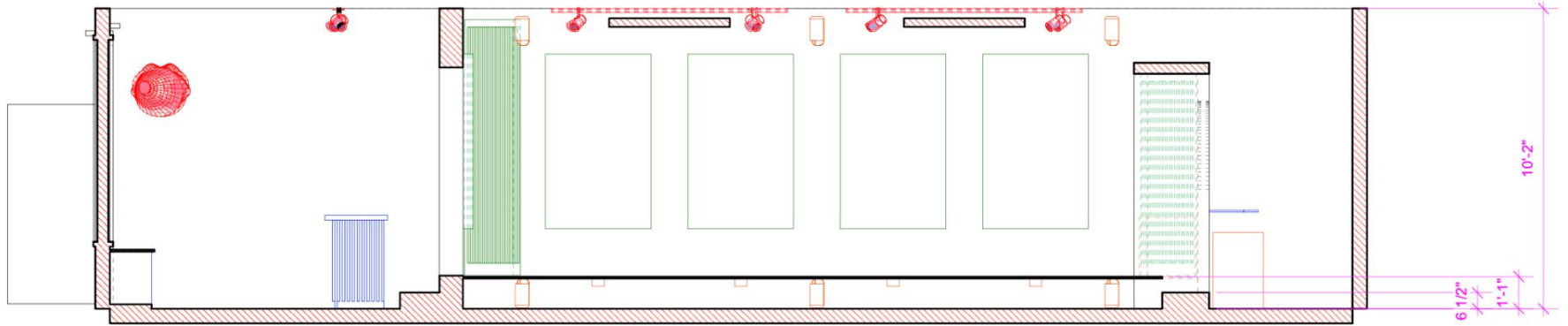

The lights will be dimmed, it will be somewhat dark, but exit lights will always be on.

You can leave and go the Lobby any time. You will not be allowed back into the studio space if you leave.

It is ok to make noise and move around.

Let us know where you would like to sit and any other support you need when you arrive.

Come 15 mins early to explore the space and get comfortable.